

# IP CCTV Cabling Solution

## IPS208P – 8-Port PoE Switch with Fiber backbone



(SFP Fiber Optic Module Not Included)

### Features

- 8x RJ45 PoE Device Port, 100 Base-T
- 1x SFP Fibre-Optic Uplink, 1000 Base-T. Solving problem of lightning & distance
- 1x Network Uplink, 100 Base-T, 150m
- PoE Protocol : IEEE802.3af
- PoE+ Power : 30W /port, 100m
- Surge Protection : 4KV, 30000h MTBF
- Reset button for individual port
- Plug and Play, 48VDC (Adapter Inc.)

### Connection Diagram

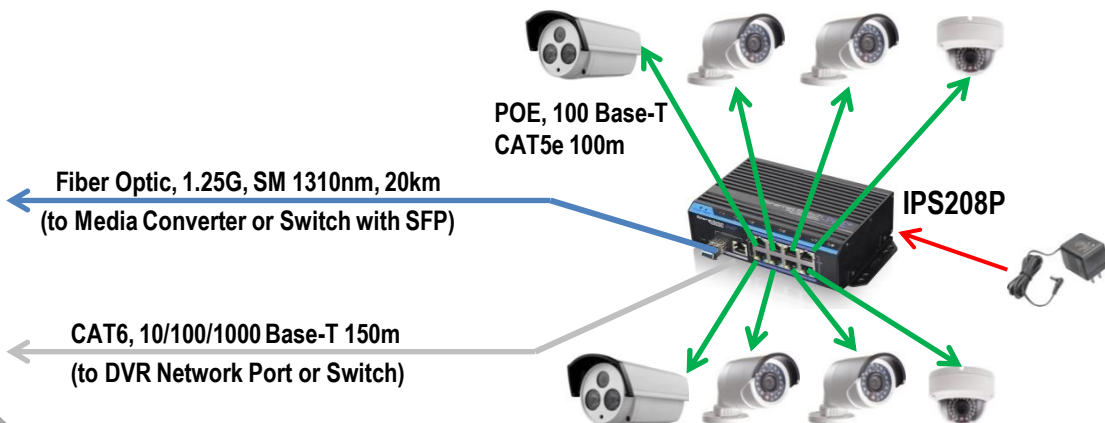

### Specification

- 48~57VDC Input, 240W Max.
- 5.6Gbps Switching Capacity, 1M Buffer
- Network Standard : IEEE802.3, 802.3u, 802.3ab, 802.3x, 802.3z
- POE Protocol : IEEE802.3af/at
- Lightning Protection : 4KV
- Operating Environment : -20~55°C / 0~95% Humidity
- Aluminum Casing with Black Epoxy Powder Coating
- Size : 159(W) x110(D) x46.5(H) mm
- Weight : 570g

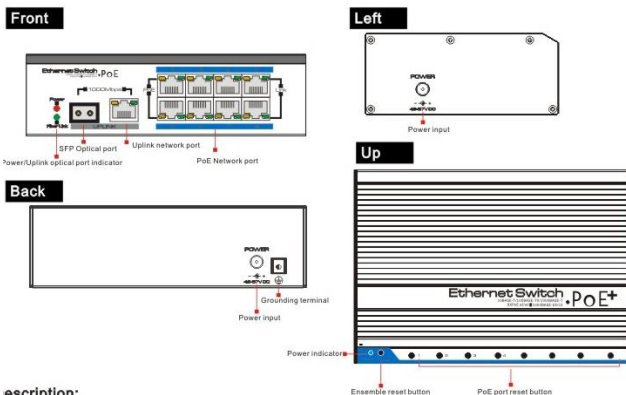

escription: