

BL40-1250 – 12V/50AH LiFePo4 Battery with BMS



2000 ~ 7000 cycles

BMS

Features

- **Light Weight**, up to 40% lighter than SLA
- **Small Size**, up to 40% smaller than SLA
- **High DOD** up to 80% (50% for SLA)
- **Long Lifespan** (cycles) 10 times than SLA
 >2000 cycles @100% DOD
 >4000 cycles @80% DOD
 >7000 cycles @50% DOD
- Build-in **BMS** (Battery Management System).
- Over charge Protection
- Over discharge Protection
- Auto Battery balancing
- Short Circuit Protection – auto recovery when short removed

SPECIFICATION

Model	BL40-1250
Nominal Voltage	12.8V
Rated Capacity	50AH
Stored Energy	640WH
Cycle Life (100% DOD)	2000 cycles
Internal Resistance	<30m Ohm
Max. Discharge (A)	50A
Charge Cut-off	15.2V
Discharge Cut-off	9.6V
Dimension	230(L) x 140(W) x 210(H)mm
Weight	8kg
Operating Temperature	0° ~ +60°C
Self Discharge	<3% per month
Life Expectancy	15 years @50% DOD
Terminal Type	Female Copper Insert M8

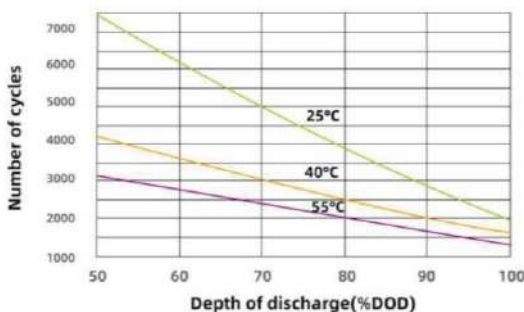
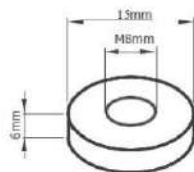
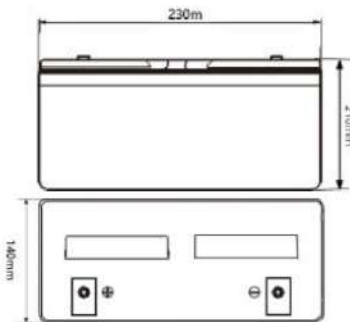

BL40-2456 – 24V 56AH LiFePo4 Battery with BMS



*Image for illustration purpose only

2000 ~ 7000 cycles

BMS

Features

- **Light Weight**, up to 40% lighter than SLA
- **Small Size**, up to 40% smaller than SLA
- **High DOD** up to 80% (50% for SLA)
- **Long Lifespan** (cycles) 10 times than SLA
 >2000 cycles @100% DOD
 >4000 cycles @80% DOD
 >7000 cycles @50% DOD
- Build-in **BMS** (Battery Management System).
- Over charge Protection
- Over discharge Protection
- Auto Battery balancing
- Short Circuit Protection – auto recovery when short removed

Charge Characteristic

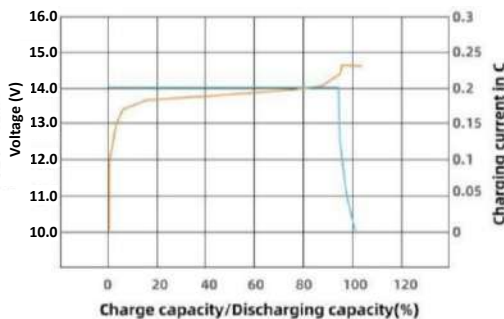

Cycle Life vs DOD & Temperature

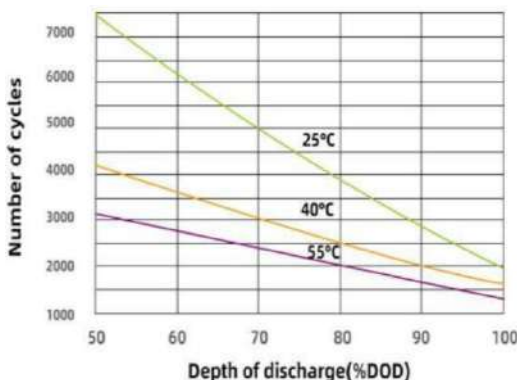

SPECIFICATION

Model	BL40-2456
Nominal Voltage	25.6V
Rated Capacity	56AH
Stored Energy	1433.6 WH
Internal Resistance	<30m Ohm
Max. Charge Current (A)	50A
Max. Discharge Current (A)	50A
Charge Cut-off	14.6V
Discharge Cut-off	10V
Dimension	260(L) x 165(W) x 210(H)mm
Weight	13.6kg
Operating Temperature	0° ~ +60°C
Self Discharge	<3% per month
Life Expectancy	15 years @50% DOD
Terminal Type	Female Copper Insert M8

* Specification may be changed without prior notice

BL40-12100 – 12V/100AH LiFePo4 Battery with BMS



2000 ~ 7000 cycles

BMS

Features

- **Light Weight**, up to 40% lighter than SLA
- **Small Size**, up to 40% smaller than SLA
- **High DOD** up to 80% (50% for SLA)
- **Long Lifespan** (cycles) 10 times than SLA
 >2000 cycles @100% DOD
 >4000 cycles @80% DOD
 >7000 cycles @50% DOD
- Build-in **BMS** (Battery Management System).
- Over charge Protection
- Over discharge Protection
- Auto Battery balancing
- Short Circuit Protection – auto recovery when short removed

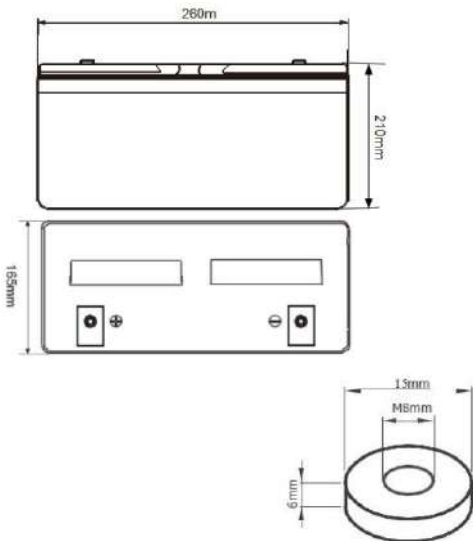

SPECIFICATION

Model	BL40-12100
Nominal Voltage	12.8V
Rated Capacity	100AH
Stored Energy	1280WH
Cycle Life (100% DOD)	2000 cycles
Internal Resistance	<30m Ohm
Max. Discharge (A)	100A
Charge Cut-off	15.2V
Discharge Cut-off	9.6V
Dimension	260(L) x 165(W) x 210(H)mm
Weight	11kg
Operating Temperature	0° ~ +60°C
Self Discharge	<3% per month
Life Expectancy	15 years @50% DOD
Terminal Type	Female Copper Insert M8

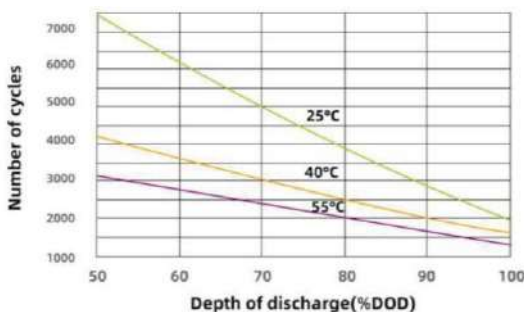

BL40-12160 – 12V/160AH LiFePo4 Battery with BMS



2000 ~ 7000 cycles

BMS

Features

- **Light Weight**, up to 40% lighter than SLA
- **Small Size**, up to 40% smaller than SLA
- **High DOD** up to 80% (50% for SLA)
- **Long Lifespan** (cycles) 10 times than SLA
 >2000 cycles @100% DOD
 >4000 cycles @80% DOD
 >7000 cycles @50% DOD
- Build-in **BMS** (Battery Management System).
- Over charge Protection
- Over discharge Protection
- Auto Battery balancing
- Short Circuit Protection – auto recovery when short removed

Charge Characteristic

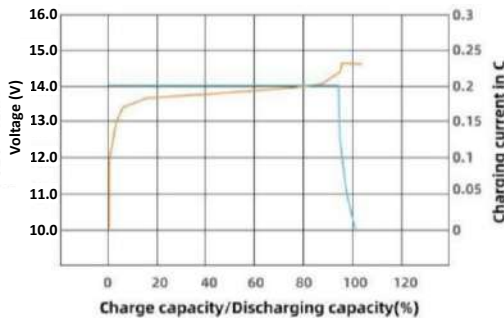

Cycle Life vs DOD & Temperature

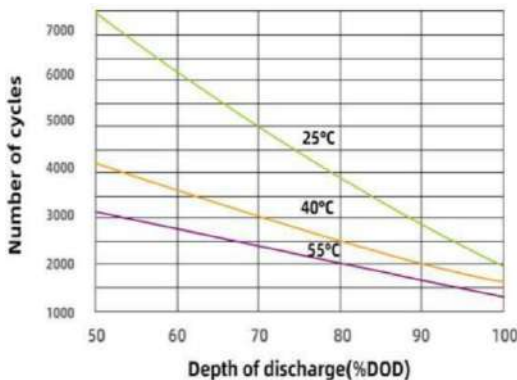

SPECIFICATION

Model	BL40-12160
Nominal Voltage	12.8V
Rated Capacity	160AH
Stored Energy	2048WH
Internal Resistance	<10m Ohm
Max. Charge Current (A)	50A
Max. Discharge Current (A)	100A
Charge Cut-off	14.6V
Discharge Cut-off	10V
Dimension	410(L) x 170(W) x 205(H)mm
Weight	13.7kg
Operating Temperature	0° ~ +60°C
Self Discharge	<3% per month
Life Expectancy	15 years @50% DOD
Terminal Type	Female Copper Insert M8

BL40-24120 – 24V 120AH LiFePo4 Battery with BMS



2000 ~ 7000 cycles

BMS

Features

- **Light Weight**, up to 40% lighter than SLA
- **Small Size**, up to 40% smaller than SLA
- **High DOD** up to 80% (50% for SLA)
- **Long Lifespan** (cycles) 10 times than SLA
 >2000 cycles @100% DOD
 >4000 cycles @80% DOD
 >7000 cycles @50% DOD
- Build-in **BMS** (Battery Management System).
- Over charge Protection
- Over discharge Protection
- Auto Battery balancing
- Short Circuit Protection – auto recovery when short removed

Charge Characteristic

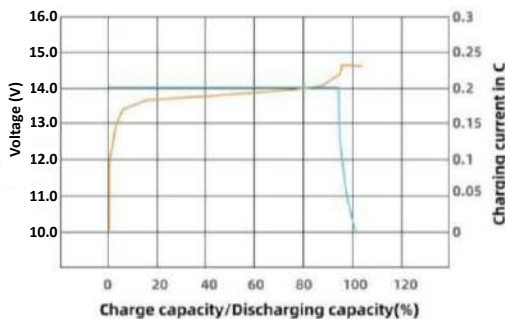

Cycle Life vs DOD & Temperature

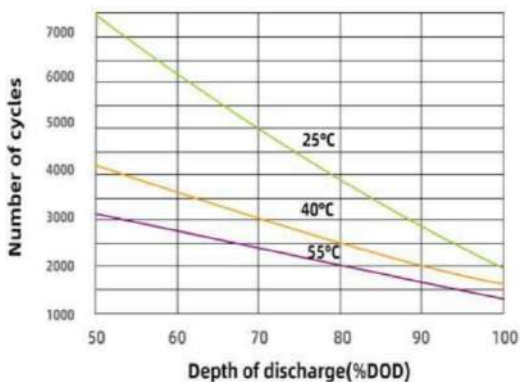

SPECIFICATION

Model	BL40-24120
Nominal Voltage	25.6V
Rated Capacity	120AH
Stored Energy	3072 WH
Internal Resistance	<10m Ohm
Max. Charge Current (A)	50A
Max. Discharge Current (A)	100A
Charge Cut-off	29.2V
Discharge Cut-off	20V
Dimension	345(L) x 190(W) x 245(H)mm
Weight	23.9kg
Operating Temperature	0° ~ +60°C
Self Discharge	<3% per month
Life Expectancy	15 years @50% DOD
Terminal Type	Female Copper Insert M8

* Specification may be changed without prior notice

BL40-48100 – 48V 100AH LiFePo4 Battery with BMS



2000 ~ 7000 cycles

BMS

Features

- **Light Weight**, up to 40% lighter than SLA
- **Small Size**, up to 40% smaller than SLA
- **High DOD** up to 80% (50% for SLA)
- **Long Lifespan** (cycles) 10 times than SLA
 >2000 cycles @100% DOD
 >4000 cycles @80% DOD
 >7000 cycles @50% DOD
- Build-in **BMS** (Battery Management System).
- Over charge Protection
- Over discharge Protection
- Auto Battery balancing
- Short Circuit Protection – auto recovery when short removed

Charge Characteristic

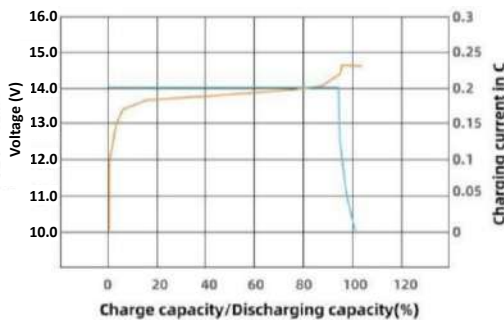

Cycle Life vs DOD & Temperature

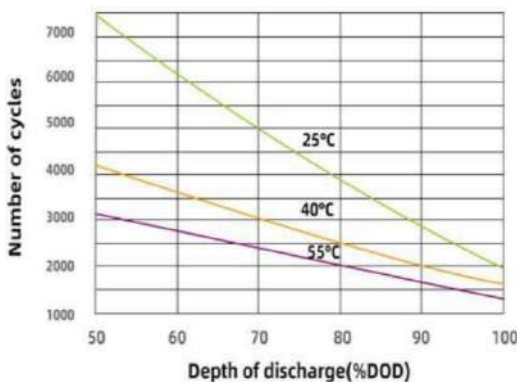

SPECIFICATION

Model	BL40-48100
Nominal Voltage	48V
Rated Capacity	100AH
Stored Energy	4800 WH
Internal Resistance	<20m Ohm
Max. Charge Current (A)	50A
Max. Discharge Current (A)	100A
Charge Cut-off	54V
Discharge Cut-off	37.5V
Dimension	520(L) x 268(W) x 230(H)mm
Weight	23.9kg
Operating Temperature	0° ~ +60°C
Self Discharge	<3% per month
Life Expectancy	15 years @50% DOD
Terminal Type	Female Copper Insert M8

BL40-51300 – 51V 300AH LiFePo4 Battery with BMS



*Image for illustration purpose only

2000 ~ 7000 cycles

BMS

Features

- **Light Weight**, up to 40% lighter than SLA
- **Small Size**, up to 40% smaller than SLA
- **High DOD** up to 80% (50% for SLA)
- **Long Lifespan** (cycles) 10 times than SLA
 >2000 cycles @100% DOD
 >4000 cycles @80% DOD
 >7000 cycles @50% DOD
- Build-in **BMS** (Battery Management System).
- Over charge Protection
- Over discharge Protection
- Auto Battery balancing
- Short Circuit Protection – auto recovery when short removed

Charge Characteristic

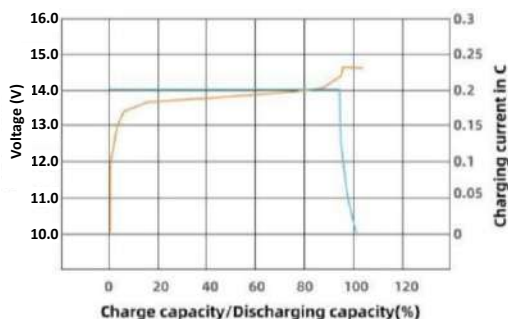

Cycle Life vs DOD & Temperature

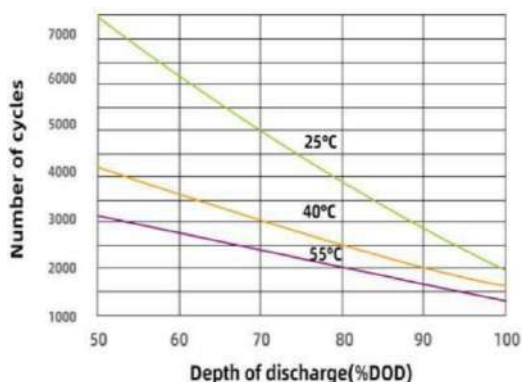

SPECIFICATION

Model	BL40-51300
Nominal Voltage	51.2V
Rated Capacity	300AH
Stored Energy	15360 WH
Internal Resistance	<50m Ohm
Max. Charge Current (A)	150A
Max. Discharge Current (A)	200A
Charge Cut-off	58V
Discharge Cut-off	42V
Dimension	897(L) x 416(W) x 247(H)mm
Weight	128kg
Operating Temperature	0° ~ +60°C
Self Discharge	<3% per month
Life Expectancy	15 years @50% DOD
Terminal Type	Female Copper Insert M8

* Specification may be changed without prior notice

CGP – System

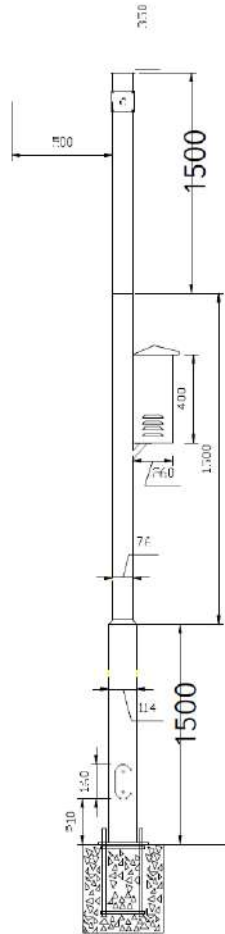

Specifications

- Modular construction for ease of assembly and installation on site
- Equipped with combination cage, lightning rod, and other complete accessories
- Material is galvanized steel pole, thickness 2mm
- Buried root is combination version
- Arm bracket for camera & outdoor cabinet (*optional*)

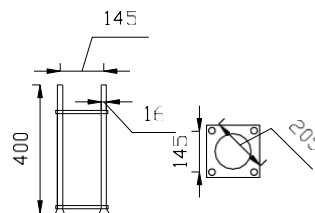

Model	CGP-30	CGP-35	CGP-40	CGP-45
Height	3 meters	3.5 meters	4 meters	4.5 meters
Material	Galvanized Steel Pole with Epoxy Powder Coat			
Pole Thickness	2mm			
Pole Diameter	76 ~ 114mm			
Surface Treatment	Electrostatic Spray			

CGP – CCTV Galvanized Steel Pole

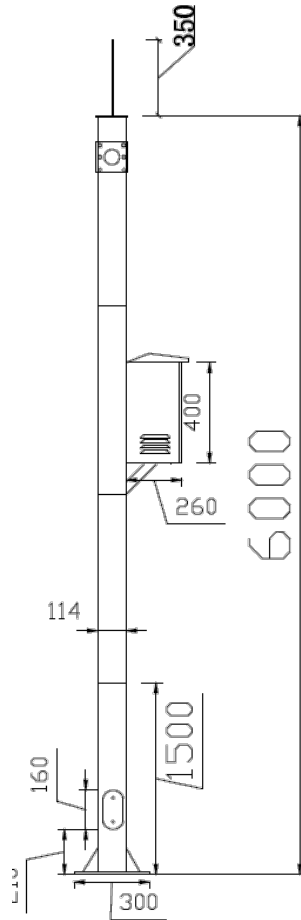

Specifications

- Modular construction for ease of assembly and installation on site
- Equipped with combination cage, lightning rod, and other complete accessories
- Material is galvanized steel pole, thickness 2mm
- Buried root is combination version
- Arm bracket for camera & outdoor cabinet (*optional*)

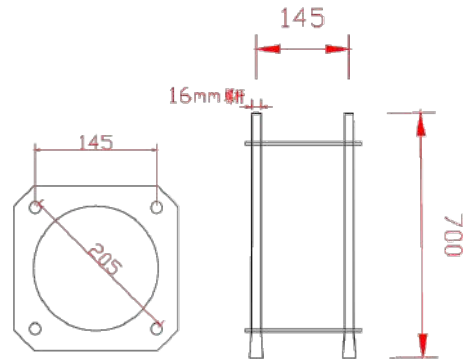

Model	CGP-430	CGP-440	CGP-445	CGP-450	CGP-455	CGP-460
Height	3 meters	4 meters	4.5 meters	5 meters	5.5 meters	6 meters
Material	Galvanized Steel Pole with Epoxy Powder Coat					
Pole Thickness	2mm					
Pole Diameter	114mm					
Surface Treatment	Electrostatics Spray					

Accessories



Enclosure Box

Model	CPC-404026	CPC-405028	CPC-455535
Material	Galvanized Steel + Epoxy Powder Coating		
Size	400*400*260mm	400*500*280mm	450*550*350mm
Thickness	0.8mm		
Surface Treatment	Electrostatic Spray		
Color	White		



Ring Hoop

Model	CPA-H300	CPA-H600	CPA-H900
Material	304 Stainless Steel		
Size	300mm	600mm	900mm
Thickness	0.6mm		
Surface Treatment	/		
Color	Silver		



Solar Panel Set

Model	CPA-S45	CPA-S45-D
Material	Galvanized Steel + Epoxy Powder Coating	
Type	c/w Arm	w/o Arm
Surface Treatment	Electrostatic Spray	
Color	White	

IPW-4GL – Outdoor 4G Router

SIRIM Approval : RAMI/73F/1021/S(21-1389)
MCMC MTF5B TC T015:2017 & T007:2020



Features

- Build-in 4G Antenna
- 2.4G Wifi 11b/g/n max 300Mbps
- DHCP
- Customized SSID & encryption
- Support 2 Sim Card (1 for standby)
- 4G Transmission up to 150Mbps download / 50Mbps upload
- Port : 1x 100Mbps WAN
1x 100Mbps LAN
- Web management, Plug & Play
- 24VDC/1A (12 to 24VDC Adapter Inc.)

SPECIFICATION

Model	IPW-4GL
DRAM	DDR2 126MByte
Flash	16MByte
Transmission	DSSS
Modulation	OFDM / BPSK / QPSK / CCK / DQPSK / DBPSL
Standard	IEEE802.11n / 802.11g / 802/11b / IEEE802.3u
Protocol	CSMA/CA. TCP/IP, IPX/SPX, NetBUEI, DHCP, NDIS3, NDIS4, NDIS5
Channel	2412 ~ 2472MHz
4G System	TDD/FDD : 150Mbps Download, 50Mbps Upload WCDMA : 21Mbps Download, 5.76Mbps Upload GPRS : 85.6kbps Download, 65.6kbps Upload EDGE : 236.8kbps Download, 11kbps Upload
Security	WEP 64/128bits, WPA, WPA2, WPA, 802.1X
Antenna	2412~2487MHz, 5DBi
Power	<10W, 24VDC PoE (Adapter Included)
Operating Temperature	-40°C ~ +80°C
Dimension	116mm(W) x 249mm(H) x 73mm(D), 0.5kg

* Specification maybe changed without prior notice

IPW0115 – 1km 150Mbps Network Extender



Features

- **1km** Line of Sight
- **150Mbps, 2.4GHz**
- 64M DDR RAM
- 10/100Mbps LAN port x1
- DIP Switch setting for easy pairing without use of PC
- Recommend for Lift, Warehouse, Store etc
- Active (Power Required) at both transmitter & receiver side
- LED indication for power & signal

Connection Diagram

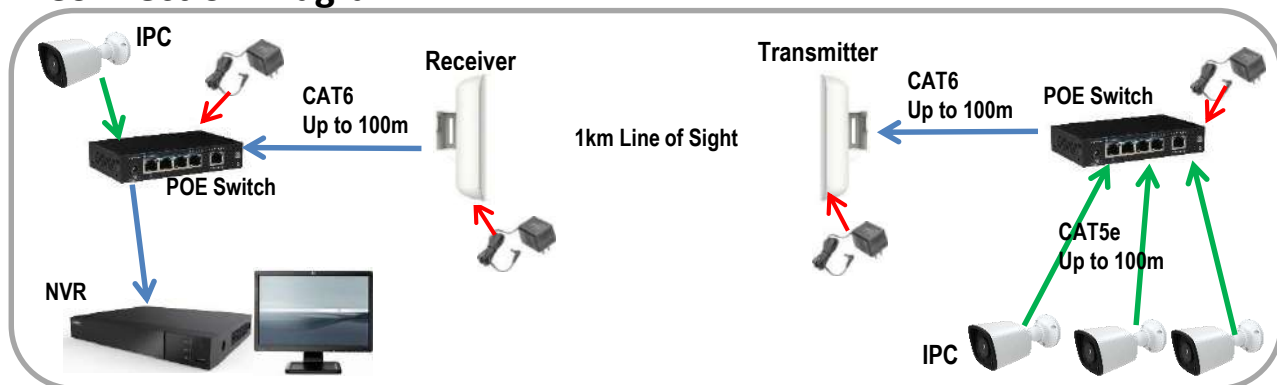

Dimension

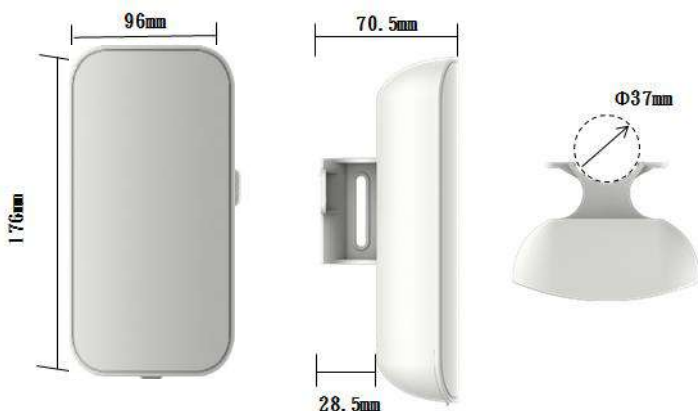

Specification

- IEEE802.11n, 11g, 11b, 802.3u
- Flash : 8MB
- IC : SiGe5012B
- DC12V, 1A
- Power Consumption <3W at both Transmitter & Receiver
- Operating Environment : -30°~65°C / 0~95% Humidity
- ABS/PC Material with UV Protection
- Dimension & Weight : 170(H) x 96(W) x 70(D)mm, 300g (same for both Tx & Rx)

IVT12-P300/600/1000 – Pure Sine Wave Inverter



IVT12-P300



IVT12-P600



IVT12-P1000

Features

- Most advance inverter with highest efficiency 92%
- 12 VDC Input. 230 VAC output
- Continuous Power 300 / 600 / 1000 W
- Low standby power consumption
- USB 5V 2A output
- **Protection :**
 - 1) Low Voltage Alarm
 - 2) Low Voltage Shutdown
 - 3) Over Voltage Shutdown
 - 4) Short Circuit Shutdown
 - 5) Over Load Shutdown
 - 6) Over heat Shutdown
- Working Temperature : -10°C ~ 50°C

Model		IVT12-P300	IVT12-P600	IVT12-P1000
Input	Voltage In	12 VDC		
	Voltage Range	10 ~ 15.5 VDC		
	Standby Power	6 W		
	Max. Efficiency	92 %		
Output	Output Voltage	230VAC 50Hz		
	Continuous Power, W	300	600	1000
	Surge Power, W	600	1200	2000
	USB	5V, 2A		
	Distortion	< 3%		
Protection	Low Voltage Alarm	10.5 V		
	Low Voltage Shutdown	10.0 V		
	Over Voltage Shutdown	15.5 V		
Dimension (mm)		212 x 142 x 65	242 x 142 x 65	318 x 189 x 81
Net Weight / Gross Weight		0.8 / 1.0 kg	1.1 / 1.2 kg	2.1 / 2.5 kg

IVT48-P3000/5000/8000 – Pure Sine Wave Inverter



Features

- Most advance inverter with highest efficiency 92%
- 48 VDC Input. 230 VAC output
- Continuous Power 3000 / 5000 / 8000 W
- Low standby power consumption
- USB 5V 2A output
- **Protection :**
 - 1) Low Voltage Alarm
 - 2) Low Voltage Shutdown
 - 3) Over Voltage Shutdown
 - 4) Short Circuit Shutdown
 - 5) Over Load Shutdown
 - 6) Over heat Shutdown
- Working Temperature : -10°C ~ 50°C

Model		IVT48-P3000	IVT48-P5000	IVT48-P8000
Input	Voltage In	48 VDC		
	Voltage Range	40 ~ 62 VDC		
	Standby Power	12 W		
	Max. Efficiency	92 %		
Output	Output Voltage	230VAC 50Hz		
	Continuous Power, W	3000	5000	8000
	Surge Power, W	6000	10000	16000
	USB	5V, 2A		
	Distortion	< 3%		
Protection	Low Voltage Alarm	42.0 V		
	Low Voltage Shutdown	40.0 V		
	Over Voltage Shutdown	62.0 V		
Dimension (mm)		426 x 235 x 97	470 x 280 x 120	520 x 280 x 120
Net Weight / Gross Weight		5.1 / 6.1 kg	7.7 / 9.1 kg	10 / 11.4 kg

MPPT-2024 – 20A Solar Charge Controller

MPPT-4024 – 40A Solar Charge Controller

MPPT-6024 – 60A Solar Charge Controller

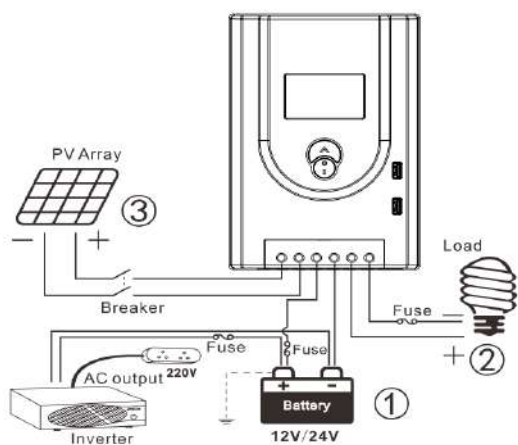

Features

- Advance **MPPT** (Max. Power Point Tracking) with efficiency >99.5%
- 30%~50% more efficient than conventional PWM controller
- Multi Stage Charging
- Support **SLA, GEL & LiFePo4** Batteries
- **12/24VDC** system auto detect
- Low voltage Load Disconnect / Re-connect
- Battery reverse polarity protection
- Load Short Circuit / Over Load Protection
- Over Temperature Protection & Temperature Compensation
- LCD screen status indication
- Dual USB 5V/2A
- **Load Control** : 1) Light 2) Reverse Light 3) Light & Timer 4) ON 5) OFF
- **Error Indication** :
E1 : Battery over discharge, E3 : Overload
E5 : Over Temperature, E6 : Solar over voltage

Model	MPPT-2024	MPPT-4024	MPPT-6024
VOC	60V	100V	100V
Max. Charge Current	20A	40A	60A
Max. Battery Voltage	8 ~ 32V		
Max. Solar Panel Input (12V)	260 W	520 W	780 W
Max. Solar Panel Input (24V)	520 W	1040 W	1560 W
Max. Discharge Current	20A	30A	30A
Static Loss	< 50mA		
Operating Temperature	-20 ~ 55°C		
Humidity	<90%, Non Condensing		
Dimension (mm)	175 x 140 x 41mm	215 x 170 x 67mm	265 x 190 x 67mm
Max. Cable Size	7AWG / 10 mm ²	5AWG / 16 mm ²	5AWG / 16 mm ²

MPPT-3024i – 30A Solar Charge Controller

MPPT-5024i – 50A Solar Charge Controller



Features

- Advance **MPPT** (Max. Power Point Tracking) with efficiency >99.5%
- 30%~50% more efficient than conventional PWM controller
- Multi Stage Charging
- Support **SLA, GEL & LiFePo4** Batteries
- **12/24VDC** system auto detect
- Low voltage Load Disconnect / Re-connect
- Battery reverse polarity protection
- Load Short Circuit / Over Load Protection
- Over Temperature Protection
- LCD screen status indication
- **Load Control** : 1) On/Off, 2) PV Voltage Control, 3) Dual Schedule, 4) PV + Time Control
- **Optional Bluetooth / Wifi Module** : charging / battery / load status, schedule output, on/off output
- IP42
- Status Indication by LED
Green: On = Load Running, Off = Load Off
Blue : Fast = Bulk Charge, On = Float
Red : On = Faulty, Off = Healthy



Model	MPPT-3024i	MPPT-5024i
VOC	100 V	150V
Max. Charge Current	30A	50A
Max. Battery Voltage	12V System : 9 ~ 15V, 24V System : 18~30V	
Max. Solar Panel Input (12V)	420W	700W
Max. Solar Panel Input (24V)	840W	1400W
Max. Load Current	20A	30A
MPPT Efficiency	> 99.5%	
Standby Mode	< 1.8W	
Low Voltage Protection	Cut-Off 10.5V, Resume 11V	
Operating Temperature	-20 ~ 55°C	
Humidity	<90%, Non Condensing	
Dimension (mm) / Weight (kg)	220 x 148 x 64mm, 1.5kg	215 x 145 x 75mm
Max. Cable Size	28 mm ²	

- MPPT-4048 – 40A Solar Charge Controller**
- MPPT-6048 – 60A Solar Charge Controller**
- MPPT-8048 – 80A Solar Charge Controller**
- MPPT-10048 – 100A Solar Charge Controller**

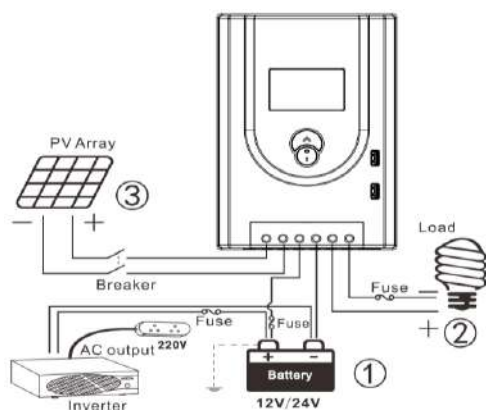

Features

- Advance **MPPT** (Max. Power Point Tracking) with efficiency >99.5%
- 30%~50% more efficient than PWM controller
- Multi Stage Charging
- Support **SLA, GEL & LiFePo4** Batteries
- **12/24/48VDC** system auto detect
- Low voltage Load Disconnect / Re-connect
- Battery reverse polarity protection
- Load Short Circuit / Over Load Protection
- Over Temperature Protection & Temperature Compensation
- LCD screen status indication
- Dual USB 5V/2A
- **Load Control** : 1) Light 2) Reverse Light 3) Light & Timer 4) ON 5) OFF
- **Optional Bluetooth (-B)** : charging / battery / load status, on/off output
- **Error Indication** :
E1 : Battery over discharge, E3 : Overload
E5 : Over Temperature, E6 : Solar over voltage

Model	MPPT-4048	MPPT-6048	MPPT-8048	MPPT-10048
VOC	150V			
Max. Charge Current	40A	60A	80A	100A
Max. Battery Voltage	12 / 24 / 48 V			
Max. Solar Panel Input (12V)	520 W	780 W	1040 W	1300 W
Max. Solar Panel Input (24V)	1040 W	1560 W	2080 W	2600 W
Max. Solar Panel Input (48V)	2080 W	3120 W	4160 W	5200 W
Standby Mode	50 mA			
Operating Temperature	-20 ~ 55°C			
Humidity	<90%, Non Condensing			
Dimension (mm)	220 x 200 x 83mm	265 x 220 x 88mm	340 x 240 x 108mm	380 x 280 x 120mm
Max. Cable Size	7AWG / 10 mm ²	5AWG / 16 mm ²	5AWG / 16 mm ²	3AWG / 25 mm ²

ENCLOSURE BOX



SPECIFICATION

Model	CPC-4040125	CPC-404026	CPC-405028	CPC-455535	CPC-507040
Material	Galvanized Steel + Epoxy Powder Coating				
Size (mm)	400*400*125	400*500*260	400*500*280	450*550*350	500*700*400
Thickness	0.8mm				
Surface Treatment	Electrostatic Spray , IP55				
Color	White				
Weight	6.8kg	8.8kg	9.7kg	13.6kg	25kg

SCP-12050-V2 120W 50AH Solar kit



Features

- Easy Installation
- Monocrystalline Solar Panel for maximum efficiency
- Single Panel design for easy transportation
- Build-in LiFePo4 – small size, light weight, high cycles, long lifespan & fast charging
- Nominal **5-years** lifespan @50% DOD
- Build-in PWM solar charger
- 12VDC output
- Wall / Pole Mount bracket included.

SPECIFICATION

Model	SCP-12050-V2
Solar Panel	120W x 1
Battery	50AH
Max. Load (24Hrs)	< 13W
Max. Output Current	5.5A
Working Environment	-40° ~ +85°C, <90° Humidity (Non Condensation)
Output Voltage	12VDC
Solar Panel Dimension	920 x 670mm
Weight	16.2kg

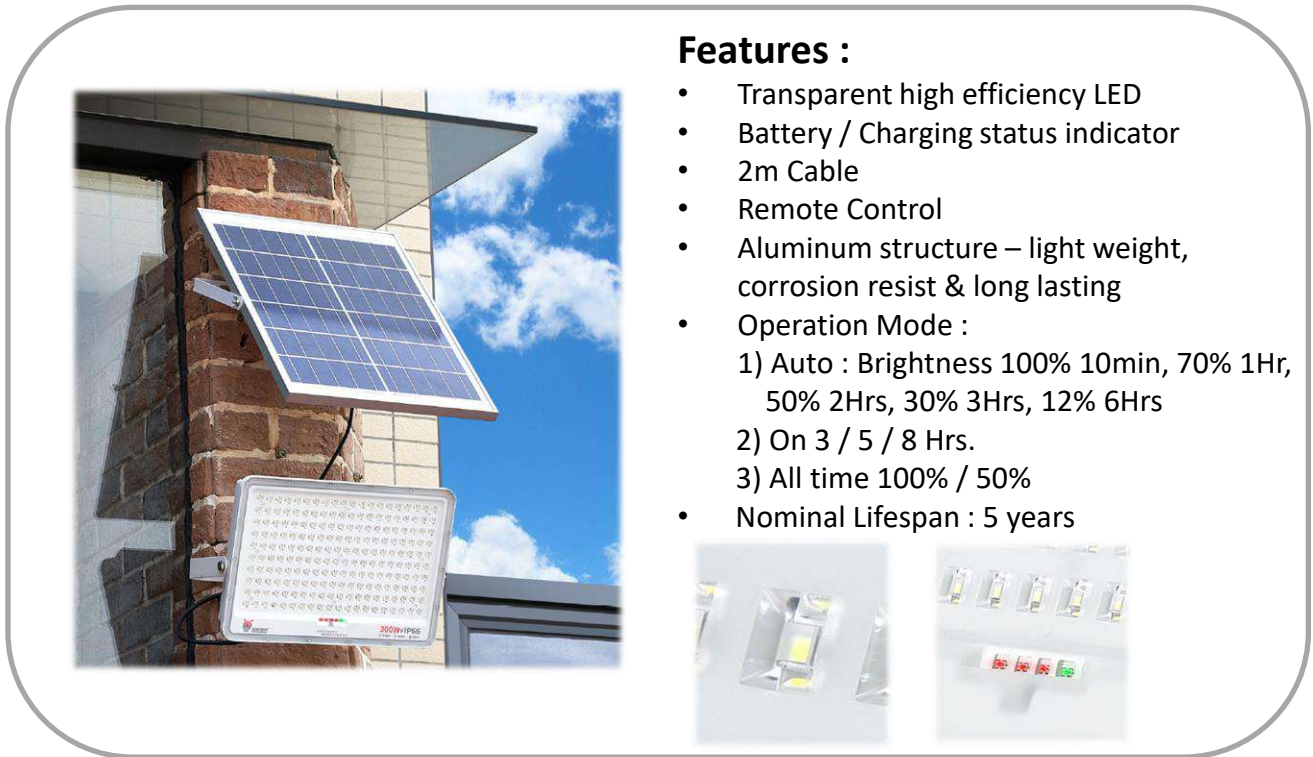

Features :

- Transparent high efficiency LED
- Battery / Charging status indicator
- 2m Cable
- Remote Control
- Aluminum structure – light weight, corrosion resist & long lasting
- Operation Mode :
 - 1) Auto : Brightness 100% 10min, 70% 1Hr, 50% 2Hrs, 30% 3Hrs, 12% 6Hrs
 - 2) On 3 / 5 / 8 Hrs.
 - 3) All time 100% / 50%
- Nominal Lifespan : 5 years

Models & Spec

Models	LEDs	Battery (LiFePo4)	Solar Panel	Dimension (Light)	Dimension (Solar Panel)
SL-60-FL	50	10AH	6V 15W	186x158x55	290x350
SL-120-FL	120	15AH	6V 20W	222x171x55	350x400
SL-200-FL	150	20AH	6V 25W	278x219x55	350x530
SL-300-FL	200	25AH	6V 30W	351x246x60	350x600



* Specification maybe changed without prior notice

Solar Panel



Malaysia Brand, Malaysia Solution, for Malaysian

SP-18160-760 – 160W/18V

SP-18200-760 – 200W/18V

SP-18250-760 – 250W/18V

SP-34300-1134 – 300W/34V

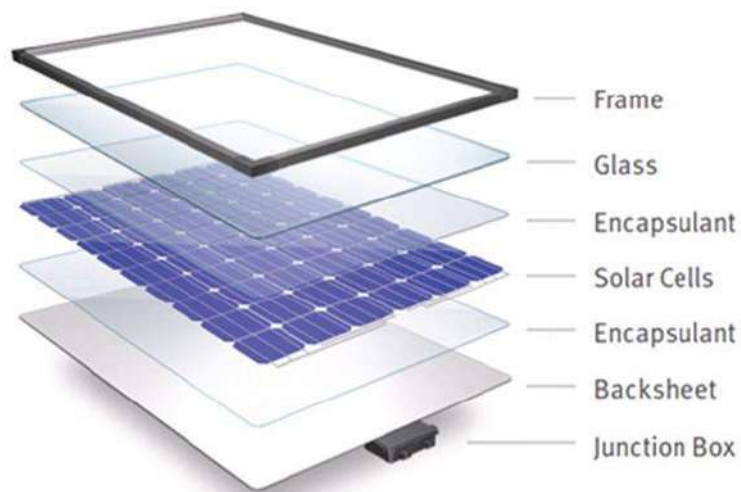

Features

- **Mono Filament**
- **Grade A New Panels**
- Efficiency : 21%
- Anodize Aluminum Frame – Light Weight, Strong & Durable
- 20 years operation without physical damage

Model	Power (W)	Voltage (V)	Current (A)	VOC (V)	Dimension (mm)	Weight (kg)
SP-18160-760	160	18	8.89	25	1040 x 760 x 30	10.5
SP-18200-760	200	18	11.11	25	1290 x 760 x 30	9.5
SP-18250-760	250	18	13.89	25	1530 x 760 x 35	11.0
SP-34300-1034	300	34	8.82	41	1290 x 1134 x 35	13.5

* Specification maybe changed without prior notice